



Marshall
Waterproofing
Professional Solutions

SPECIFICATION
FOR
PRO-DRAIN 8



PRO-DRAIN 8 SPECIFICATION

PRODUCT DESCRIPTION

Pro-Drain 8 is a dimpled sheet product developed specifically for below ground waterproofing protection. Pro-Drain 8 is black in colour and manufactured from High Density Polyethylene (HDPE). The sheet thickness is 0.6 mm with a dimple height of 8mm. Pro-Drain 8 is available in 2.1 x 1.2m (2.52m²) sheets or 8.4m x 1.2m (10.08m²) rolls.

FEATURES AND BENEFITS

- The close dimple spacing of Pro-Drain 8 provides sheet stability and a compressive strength of up to 250 kN/m² (25 t/m²).
- Pro-Drain 8 is non polluting to drinking water.
- Pro-Drain 8 keeps water from reaching the wall surface and creates a neutral pressure zone between the foundation wall and subsoil.
- Pro-Drain 8 provides ventilation over the wall surface and additional thermal insulation.
- Pro-Drain 8 is extremely durable, rot-proof and impervious to root penetration.
- Pro-Drain 8 is fast and easy to install and will conform to curved walls.
- Pro-Drain 8 can be used as protection for all foundation waterproofing systems and behind timber retaining walls to divert moisture.
- The sheets stack into each other, making Pro-Drain 8 very economical to transport and store.

SHELF LIFE

Pro-Drain 8 has an indefinite shelf life, however care should be taken to ensure the product is not exposed to chemicals or extreme conditions that may effect its integrity.

PREPARATION

Below ground waterproofing is a critical area of building construction. Ensure the tanking system is installed to a very high standard and to specification.

Ensure the tanking is clear of any debris or material that may puncture the waterproofing surface.

Make sure sufficient and safe working space has been provided.

INSTALLATION

Pro-Drain 8 must be installed with the raised dimples against the tanking surface.

Pro-drain 8 can be installed either horizontally or vertically with the sheets or rolls overlapped by two dimples to form a continuous protection layer.

The **Protecto Wrap** Tanking system has a release film on its outer face. This is removed prior to the installation of the Pro-Drain 8 to expose a highly adhesive surface.

- Position the Pro-Drain 8 against the tanking and press firmly onto the adhesive surface. This should be sufficient to hold the Pro-Drain 8 in place until the backfilling can be completed.
- Where sheet joining overlaps are required, a neutral cure adhesive is applied at intervals to the dimple hollows of the first sheet. The overlapping two rows of the second sheet are then pressed firmly into the matching dimples. This will hold the sheet overlaps together and ensure no debris can reach the waterproofing.

PRO-DRAIN 8

INSTALLATION (Continued)

For **Other Tanking Systems** where the outer surface is not adhesive, then adhesive patches or adhesive sealants must be used to hold the sheets in position.

Always check the compatibility of sealants and adhesives with any tanking system before applying.

- Option 1 - Apply small amounts of neutral cure adhesive at regular intervals across the raised dimples of the Pro-Drain 8 and press the Pro-Drain 8 into place.

Some supporting timbers may be required to hold the sheet in place until the adhesive has sufficiently cured.

- Option 2 - Spray Protecto Wrap Tak primer at regular intervals onto the Pro-Drain 8 raised dimples. Remove the backing paper from small squares of Protecto Wrap detail tape and adhere them to the sprayed dimples. Remove the release film from the detail tape and spray the tape with Tak primer. Position the Pro-Drain 8 against the wall and press firmly into place.

- Where sheet joining overlaps are required, a neutral cure adhesive is applied at intervals to the dimple hollows of the first sheet. The overlapping two rows of the second sheet are then pressed firmly into the matching dimples. This will hold the sheet overlaps together and ensure no debris can puncture the waterproofing.

SEALING THE TOP OF THE SHEET

It is important that no debris can enter the drainage cavity between the Pro-Drain 8 and the waterproofing. Any foreign material that enters this space has the potential to damage the integrity of the tanking

- Spray a band of Protecto Tak Primer along the top of the Pro-Drain 8 sheet and onto the waterproofing. (Tak primer is compatible with Protecto Wrap Tanking however it is advisable to check the compatibility of the Primer with other tanking products)

- Apply a length of Protecto Tape along the top edge junction of the Pro-Drain 8 and the tanking.
- Press and mould firmly into place.

Apply Protecto Wrap JS160H mastic to any tape joins and along the top edge of the tape. The tape is not UV stable and must be covered within 6 weeks of installation by either coating in plaster or painting with a waterbased paint.

If required Protecto Tape can be continued from the top of the Pro-Drain 8 to finish up behind the cladding. The tape is Branz appraised as a plasterable flashing tape.

DRAINAGE MUST BE PROVIDED AT THE BASE OF THE WALL

Installation must comply with E2/AS1 of the NZBC

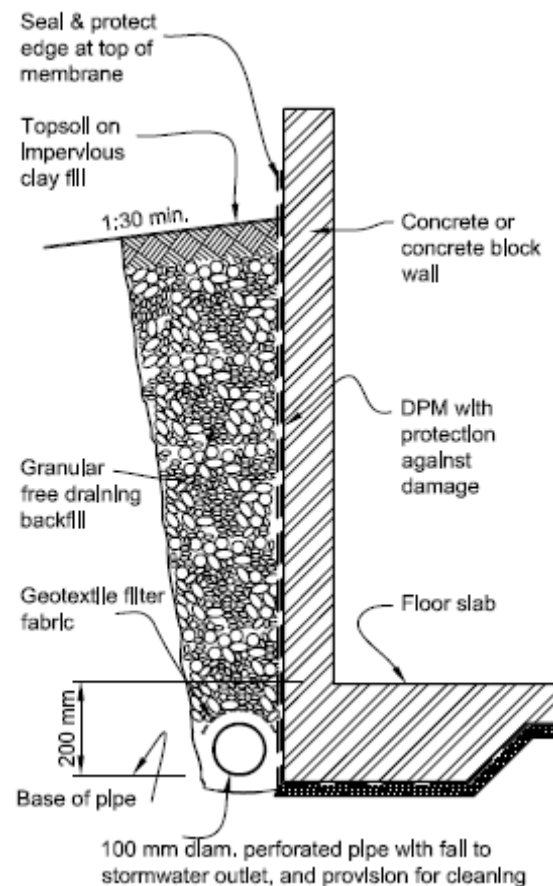

PRO-DRAIN 8